

SCALE 5:1

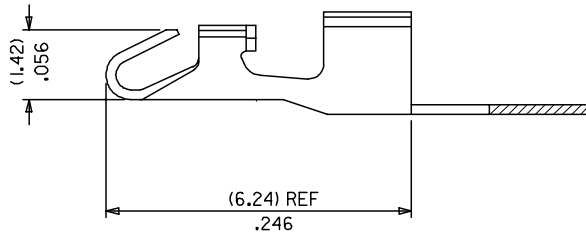

NOTES.

1. MATERIAL: (0.20)/.008 PHOSPHOR BRONZE
2. PLATING: HOT TIN DIP
3. TERMINAL WILL ACCOMMODATE
 - 22 AWG SOLID OR FUSED WIRE
 - 24 AND 26 AWG SOLID, STRANDED OR FUSED WIRE WITH (1.52)/.060 MAX. INSULATION DIA.
4. P.C.B. MOUNTING HOLE:
 - 22 AWG DIA (1.23/1.30)-.048/.051
 - 24 AND 26 AWG DIA (1.17/1.25)-.046/.049
5. MAX. P.C.B. THICKNESS (1.19±0.20)/.047±.008

UPDATED BORDER EC NO: E2007-0844 DRWN:DMAHER CHKD: APPR:EFOLAN 2007/04/05 2007/04/12 2007/04/13	QUALITY SYMBOLS ▽=0 ◻=0	GENERAL TOLERANCES (UNLESS SPECIFIED)		DIMENSION STYLE MM/IN		SCALE 10:1	DESIGN UNITS METRIC	THIRD ANGLE PROJECTION		
				mm	INCH	DRAWN BY CTOB IN	DATE 98/07/06	TITLE PCM CRIM TERM BRD-IN STAND ALONE 1TNL		
				4 PLACES ± ---	± ---	CHECKED BY TMAHON	DATE 98/07/06			
				3 PLACES ± ---	± .008	APPROVED BY MWILHITE	DATE 98/07/06	MOLEX INCORPORATED		
		2 PLACES ± 0.20	± .015	MATERIAL NO. 901980002	DOCUMENT NO. SD-90198	SHEET NO. 2 OF 2				
		1 PLACE ± 0.38	± ---	DRAFT WHERE APPLICABLE MUST REMAIN WITHIN DIMENSIONS		THIS DRAWING CONTAINS INFORMATION THAT IS PROPRIETARY TO MOLEX INCORPORATED AND SHOULD NOT BE USED WITHOUT WRITTEN PERMISSION				